

# Silicone Hose and Heavy Duty Clamps

## From WARNCO 1-877-472-7748



*Compare and Save on...*



**CAC Hose**



**Silicone Heater Hose**



**2 Ply, 3 Ply, 4 Ply  
Silicone Stick Hose**



**Constant  
Tension  
Clamps**



**T-Bolt  
Clamps**



# SILICONE COOLANT HOSES

Temperature Range -65° F TO +350° F

12 foot long sold in 3ft increments

Available in Blue, Black, Red in

Matte or Glossy finishes.

Blue is stocked color.

## 2 PLY WIRE REINFORCED SILICONE COOLANT HOSE

ID	PART#
1/4"	5579-0250
5/16"	5579-0312
3/8"	5579-0375
1/2"	5579-0500
5/8"	5579-0625
3/4"	5579-0750
7/8"	5579-0875
1"	5579-1000
1-1/8"	5579-1125
1-1/4"	5579-1250
1-5/16"	5579-1313
1-3/8"	5579-1375
1-1/2"	5579-1500
1-5/8"	5579-1625
1-3/4"	5579-1750
1-7/8"	5579-1875
2"	5579-2000
2-1/8"	5579-2125
2-1/4"	5579-2250
2-5/16"	5579-2313
2-3/8"	5579-2375
2-1/2"	5579-2500
2-5/8"	5579-2625
2.75	5579-2750
2-7/8"	5579-2875
3"	5579-3000
3-1/8"	5579-3125
3-1/4"	5579-3250
3-3/8"	5579-3375
3-1/2"	5579-3500
3-5/8"	5579-3625
3-3/4"	5579-3750
4"	5579-4000
4-1/2"	5579-4500
5"	5579-5000
6"	5579-6000

## 3 PLY POLYESTER REINFORCED SILICONE COOLANT HOSE

ID	PART#
1/4"	5515-0250
5/16"	5515-0312
3/8"	5515-0375
1/2"	5515-0500
5/8"	5515-0625
3/4"	5515-0750
7/8"	5515-0875
1"	5515-1000
1-1/8"	5515-1125
1-1/4"	5515-1250
1-5/16"	5515-1313
1-3/8"	5515-1375
1-1/2"	5515-1500
1-5/8"	5515-1625
1-3/4"	5515-1750
1-7/8"	5515-1875
2"	5515-2000
2-1/8"	5515-2125
2-1/4"	5515-2250
2-5/16"	5515-2313
2-3/8"	5515-2375
2-1/2"	5515-2500
2-5/8"	5515-2625
2.75	5515-2750
2-7/8"	5515-2875
3"	5515-3000
3-1/8"	5515-3125
3-1/4"	5515-3250
3-3/8"	5515-3375
3-1/2"	5515-3500
3-5/8"	5515-3625
3-3/4"	5515-3750
4	5515-4000
4-1/2"	5515-4500
5	5515-5000
6	5515-6000

## 4 PLY POLYESTER REINFORCED SILICONE COOLANT HOSE

ID	PART#
1/4"	5581-0250
5/16"	5581-0312
3/8"	5581-0375
1/2"	5581-0500
5/8"	5581-0625
3/4"	5581-0750
7/8"	5581-0875
1"	5581-1000
1-1/8"	5581-1125
1-1/4"	5581-1250
1-5/16"	5581-1313
1-3/8"	5581-1375
1-1/2"	5581-1500
1-5/8"	5581-1625
1-3/4"	5581-1750
1-7/8"	5581-1875
2"	5581-2000
2-1/8"	5581-2125
2-1/4"	5581-2250
2-5/16"	5581-2313
2-3/8"	5581-2375
2-1/2"	5581-2500
2-5/8"	5581-2625
2-3/4"	5581-2750
2-7/8"	5581-2875
3"	5581-3000
3-1/8"	5581-3125
3-1/4"	5581-3250
3-3/8"	5581-3375
3-1/2"	5581-3500
3-5/8"	5581-3625
3-3/4"	5581-3750
4	5581-4000
4-1/2"	5581-4500
5	5581-5000
6	5581-6000



**1 PLY POLYESTER REINFORCED  
SILICONE HEATER HOSE**

Temp. Range  
-65° F to +350° F  
Bulk reels available.

ID	PART#
1/4"	5526-0250
5/16"	5526-0313
3/8"	5526-0375
1/2"	5526-0500
5/8"	5526-0625
3/4"	5526-0750
7/8"	5526-0875
1"	5526-1000
1-1/8"	5526-1125
1-1/4"	5526-1250

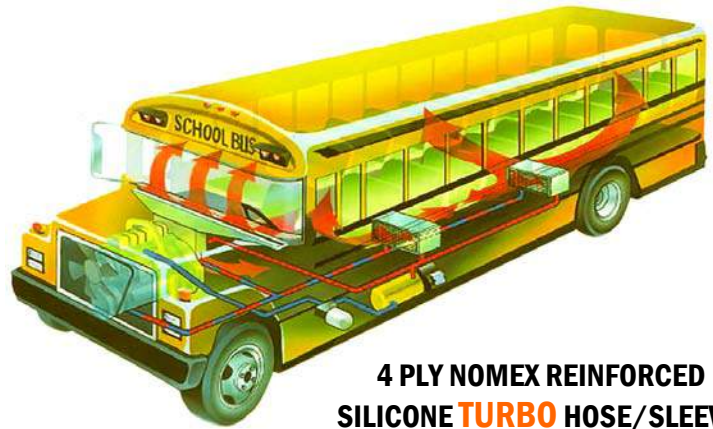

**4 PLY NOMEX REINFORCED  
SILICONE TURBO HOSE/SLEEVE**

Temp. Range -65° F TO 500° F

12 feet long



ID	PART#
1/4"	TFT40-0250
5/16"	TFT40-0312
3/8"	TFT40-0375
1/2"	TFT40-0500
5/8"	TFT40-0625
3/4"	TFT40-0750
7/8"	TFT40-0875
1"	TFT40-1000
1-1/8"	TFT40-1125
1-1/4"	TFT40-1250
1-5/16"	TFT40-1313
1-3/8"	TFT40-1375
1-1/2"	TFT40-1500
1-5/8"	TFT40-1625
1-3/4"	TFT40-1750
1-7/8"	TFT40-1875
2"	TFT40-2000
2-1/8"	TFT40-2125
2-1/4"	TFT40-2250
2-5/16"	TFT40-2313
2-3/8"	TFT40-2375
2-1/2"	TFT40-2500
2-5/8"	TFT40-2625
2.75	TFT40-2750
2-7/8"	TFT40-2875
3"	TFT40-3000
3-1/8"	TFT40-3125
3-1/4"	TFT40-3250
3-3/8"	TFT40-3375
3-1/2"	TFT40-3500
3-5/8"	TFT40-3625
3-3/4"	TFT40-3750
4"	TFT40-4000
4-1/2"	TFT40-4500
5"	TFT40-5000
6"	TFT40-6000

**HIGH PERFORMANCE SILICONE VACUUM TUBING**

PART#	SIZE
TFV-012	1/8"
TFV-016	5/32"
TFV-018	3/16"
TFV-025	1/4"
TFV-031	5/16"
TFV-038	3/8"
TFV-050	1/2"
TFV-062	5/8"
TFV-075	3/4"



25', 50' 100' and 500' Lengths  
Available in Blue, Red or Black

**Hot Side CAC**

PART#	SIZE	LENGTH
TFCA-N30-R6	3"	6"
TFCA-N35-R6	3.5"	6"
TFCA-N40-R6	4"	6"
TFCA-N40-R8	4"	8"

**Cold Side CAC**

PART#	SIZE	LENGTH
TFCA-P30-R6	3"	6"
TFCA-P35-R6	3.5"	6"
TFCA-P40-R6	4"	6"
TFCA-P40-R8	4"	8"

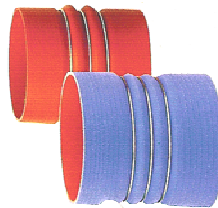

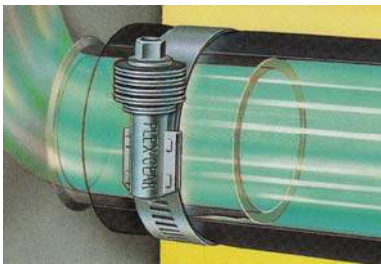

Ideal Flex Gear clamps adjust with the hose and fitting to maintain constant tension on the connection, eliminating leaks.



Hose installed with unlined clamp.



Hose installed with lined clamp.



**LINED CLAMPS FOR SILICONE HOSES**  
**613 is PARTIAL STAINLESS CONSTRUCTION**  
**615 is ALL STAINLESS CONSTRUCTION**

**LIGHTER DUTY CONSTANT TENSION**  
**ALL STAINLESS CONSTRUCTION**

SIZE	IDEAL	SAE
RANGE	Part #	Sizes
9/16" TO 1-1/16"	47010	10
5/8" TO 1-1/4"	47012	12
13/16" TO 1-1/2"	47016	16
13/16" TO 1-3/4"	47020	20
1-1/16" TO 2"	47024	24
1-5/16" TO 2-1/4"	47028	28
1-9/16" TO 2-1/2"	47032	32
1-13/16" TO 2-3/4"	47036	36
2-1/16" TO 3"	47040	40
2-15/16" TO 3-1/4"	47044	44
2-9/16" TO 3-1/2"	47048	48

Part #	SIZE RANGE	Part #
613-006	5/8 to 7/8	615-006
613-008	5/8 to 1	615-008
613-010	3/4 to 1-1/16	615-010
613-012	7/8 to 1-1/4	615-012
613-016	1 to 1-1/2	615-016
613-020	1-1/8 to 1-3/4	615-020
613-024	1-1/4 to 2	615-024
613-028	1-5/16 to 2-1/4	615-028
613-032	1-9/16 to 2-1/2	615-032
613-036	1-13/16 to 2-3/4	615-036
613-040	2-1/16 to 3	615-040
613-044	2-5/16 to 3-1/4	615-044
613-048	2-9/16 to 3-1/2	615-048
613-052	2-13/16 to 3-3/4	615-052
613-056	3-1/16 to 4	615-056
613-060	3-5/16 to 4-1/4	615-060
613-064	3-9/16 to 4-1/2	615-064
613-072	4-1/16 to 5	615-072

**HEAVY DUTY CONSTANT TENSION**  
**ALL STAINLESS CONSTRUCTION**

SIZE	IDEAL	SAE
RANGE	Part #	Sizes
1" TO 1-3/4"	45175	175
1-1/4" TO 2-1/8"	45200	212
1-3/4" TO 2-5/8"	45250	262
2-1/4" TO 3-1/8"	45300	312
2-3/4" TO 3-5/8"	45350	362
3-1/4" TO 4-1/8"	45400	412
3-3/4" TO 4-5/8"	45450	462
4-1/4" TO 5-1/8"	45500	512
4-3/4" TO 5-5/8"	45550	562
5-1/4" TO 6-1/8"	45600	612
5-3/4" TO 6-5/8"	45650	662
6-1/4" TO 7-1/8"	45700	712
6-3/4" TO 7-5/8"	45750	762
7-1/4" TO 8-1/8"	45800	812
7-3/4" TO 8-5/8"	45850	862
8-1/4" TO 9-1/8"	45900	912

**T-BOLTS**

**A Full Selection of T-Bolt Clamps**  
**All SAE Sizes and Styles available**  
**Call TOLL FREE: 1-877-472-7748**  
**For more information.**



**T-Bolt** clamps provide uniform sealing pressure for a positive, reliable seal. Designed for use in high vibration and large diameter applications common in heavy trucks, industrial machinery, off-road equipment, agricultural irrigation and machinery. Features a 3/4" or 7/8" wide stainless steel band, depending upon size ordered, and welded construction for reliability.

### Standard T-Bolt Ideal-Tridon 30010



1/4" T-Bolt



Plated Carbon Steel

7/16" Hex Nut



Plated Carbon Steel  
Nylon Insert

3/4" Band



300 Stainless

3/4" Bridge



300 Stainless

Trunnion



Plated Carbon Steel

### Standard T-Bolt Ideal-Tridon 30011

1/4" T-Bolt



300 Stainless

7/16" Hex Nut



300 Stainless  
Nylon Insert

3/4" Band



300 Stainless

3/4" Bridge



300 Stainless

Trunnion



300 Stainless

### Channel Bridge T-Bolt Ideal-Tridon 30020



1/4" T-Bolt



300 Stainless

7/16" Hex Nut



Plated Carbon Steel  
Nylon Insert

3/4" Band



300 Stainless

3/4" Bridge



300 Stainless

Trunnion



Plated Carbon Steel

### Channel Bridge T-Bolt Ideal-Tridon 30021

1/4" T-Bolt



300 Stainless

7/16" Hex Nut



300 Stainless  
Nylon Insert

3/4" Band



300 Stainless

3/4" Bridge



300 Stainless

Trunnion



300 Stainless

Note: 7/8" wide bands and custom options by request

# FIND YOUR PART NUMBER

Size	Min (in)	Max (in)	Min (mm)	Max (mm)	Standard T-Bolt		Channel Bridge	
					Ideal-Tridon 30010	Ideal-Tridon 30011	Ideal-Tridon 30020	Ideal-Tridon 30021
138	1.38	1.57	35.1	39.9	30010-0138	30011-0138	30020-0138	30021-0138
150	1.50	1.69	38.1	42.9	30010-0150	30011-0150	30020-0150	30021-0150
163	1.63	1.88	41.3	47.8	30010-0163	30011-0163	30020-0163	30021-0163
175	1.75	2.00	44.5	50.8	30010-0175	30011-0175	30020-0175	30021-0175
188	1.88	2.19	47.6	55.6	30010-0188	30011-0188	30020-0188	30021-0188
200	2.00	2.31	50.8	58.7	30010-0200	30011-0200	30020-0200	30021-0200
213	2.13	2.44	54.1	62.0	30010-0213	30011-0213	30020-0213	30021-0213
225	2.25	2.56	57.2	65.0	30010-0225	30011-0225	30020-0225	30021-0225
238	2.38	2.69	60.3	68.3	30010-0238	30011-0238	30020-0238	30021-0238
250	2.50	2.81	63.5	71.4	30010-0250	30011-0250	30020-0250	30021-0250
263	2.63	2.94	66.7	74.7	30010-0263	30011-0263	30020-0263	30021-0263
275	2.75	3.06	69.9	77.7	30010-0275	30011-0275	30020-0275	30021-0275
288	2.88	3.19	73.0	81.0	30010-0288	30011-0288	30020-0288	30021-0288
300	3.00	3.31	76.2	84.1	30010-0300	30011-0300	30020-0300	30021-0300
313	3.13	3.44	79.4	87.4	30010-0313	30011-0313	30020-0313	30021-0313
325	3.25	3.56	82.6	90.4	30010-0325	30011-0325	30020-0325	30021-0325
338	3.38	3.69	85.7	93.7	30010-0338	30011-0338	30020-0338	30021-0338
350	3.50	3.81	88.9	96.8	30010-0350	30011-0350	30020-0350	30021-0350
363	3.63	3.94	92.1	100.1	30010-0363	30011-0363	30020-0363	30021-0363
375	3.75	4.06	95.3	103.1	30010-0375	30011-0375	30020-0375	30021-0375
400	4.00	4.31	101.6	109.5	30010-0400	30011-0400	30020-0400	30021-0400
425	4.25	4.56	108.0	115.8	30010-0425	30011-0425	30020-0425	30021-0425
450	4.50	4.81	114.3	122.2	30010-0450	30011-0450	30020-0450	30021-0450
475	4.75	5.06	120.7	128.5	30010-0475	30011-0475	30020-0475	30021-0475
500	5.00	5.31	127.0	134.9	30010-0500	30011-0500	30020-0500	30021-0500
525	5.25	5.56	133.4	141.2	30010-0525	30011-0525	30020-0525	30021-0525
550	5.50	5.81	139.7	147.6	30010-0550	30011-0550	30020-0550	30021-0550
575	5.75	6.06	146.1	153.9	30010-0575	30011-0575	30020-0575	30021-0575
600	6.00	6.31	152.4	160.3	30010-0600	30011-0600	30020-0600	30021-0600
625	6.25	6.56	158.8	166.6	30010-0625	30011-0625	30020-0625	30021-0625
650	6.50	6.81	165.1	173.0	30010-0650	30011-0650	30020-0650	30021-0650
675	6.75	7.06	171.5	179.3	30010-0675	30011-0675	30020-0675	30021-0675
700	7.00	7.31	177.8	185.7	30010-0700	30011-0700	30020-0700	30021-0700
725	7.25	7.56	184.2	192.0	30010-0725	30011-0725	30020-0725	30021-0725
750	7.50	7.81	190.5	198.4	30010-0750	30011-0750	30020-0750	30021-0750
775	7.75	8.06	196.9	204.7	30010-0775	30011-0775	30020-0775	30021-0775
800	8.00	8.31	203.2	211.1	30010-0800	30011-0800	30020-0800	30021-0800
825	8.25	8.56	209.6	217.4	30010-0825	30011-0825	30020-0825	30021-0825
850	8.50	8.81	215.9	223.8	30010-0850	30011-0850	30020-0850	30021-0850

Additional sizes available

**Spring Loaded T-Bolt** clamps provide uniform sealing pressure for a positive, reliable seal. Designed for use in high vibration and large diameter applications common in heavy trucks, industrial machinery, off-road equipment, agricultural irrigation and machinery. Features a spring-loaded t-bolt assembly, a 3/4" wide stainless steel band and welded construction for reliability.

## Spring Loaded T-Bolt Ideal-Tridon 30030



1/4" T-Bolt



Plated Carbon Steel

7/16" Hex Nut



Plated Carbon Steel  
Nylon Insert

3/4" Band Width



300 Stainless

3/4" Bridge



300 Stainless

Trunnion



Plated Carbon Steel

Spring



Steel

### FIND YOUR PART NUMBER

Size	Min (in)	Max (in)	Min (mm)	Max (mm)	Ideal-Tridon 30030
225	2.250	2.563	57.2	65.1	30030-0225
275	2.750	3.063	69.9	77.8	30030-0275
300	3.000	3.313	76.2	84.1	30030-0300
306	3.063	3.375	77.8	85.7	30030-0306
313	3.125	3.438	79.4	87.3	30030-0313
325	3.250	3.563	82.6	90.5	30030-0325
338	3.375	3.688	85.7	93.7	30030-0338
350	3.500	3.813	88.9	96.8	30030-0350
356	3.563	3.875	90.5	98.4	30030-0356
363	3.625	3.938	92.1	100.0	30030-0363
375	3.750	4.063	95.3	103.2	30030-0375
400	4.000	4.313	101.6	109.5	30030-0400
406	4.063	4.375	103.2	111.1	30030-0406
425	4.250	4.563	108.0	115.9	30030-0425
450	4.500	4.813	114.3	122.2	30030-0450
456	4.563	4.875	115.9	123.8	30030-0456
475	4.750	5.063	120.7	128.6	30030-0475
500	5.000	5.313	127.0	134.9	30030-0500
506	5.063	5.375	128.6	136.5	30030-0506
525	5.250	5.563	133.4	141.3	30030-0525
550	5.500	5.813	139.7	147.6	30030-0550
575	5.750	6.063	146.1	154.0	30030-0575
625	6.250	6.563	158.8	166.7	30030-0625
650	6.500	6.813	165.1	173.0	30030-0650
750	7.500	7.813	190.5	198.4	30030-0750

**V-Bands** seal connections for flanged joints. Typical applications include filter housings, turbocharger systems, exhaust systems and industrial applications where a flanged connection is required. V-inserts can be manufactured to OE specifications and are made to order. Additional alloys are available for severe environments.



### V-Band

1/4" T-Bolt



410 Stainless

7/16" Hex Nut



300 Stainless

Band with V-Insert



300 Stainless

Trunnion



300 Stainless

### HOW TO SPECIFY YOUR V-BAND

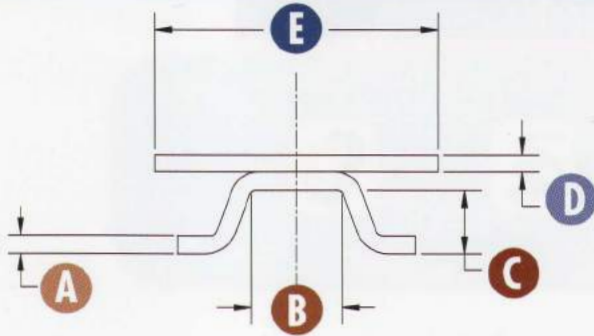

### FIND YOUR PART NUMBER

Nominal Dia. (in)	V-Insert			Band		Ideal-Tridon 24000
	A	B	C	D	E	
3.21	0.050	0.262	0.141	0.035	0.750	24000-0321
3.88	0.050	0.400	0.281	0.040	0.875	24000-0388
4.25	0.050	0.400	0.281	0.040	0.875	24000-0425
4.61	0.050	0.156	0.218	0.035	0.750	24000-0461
4.75	0.050	0.400	0.281	0.040	0.875	24000-0475
5.25	0.050	0.262	0.141	0.035	0.750	24000-0525
5.88	0.050	0.400	0.281	0.040	0.875	24000-0588

**Specialty V-Bands** for specific OE applications are available, such as the Univee and the Clam Shell. For information on how we can custom engineer a product for your specific application, contact your IDEAL-TRIDON sales representative.



### Univee V-Band

1/4" T-Bolt



420 Stainless

Band with V-Insert



300 Stainless

Trunnion



300 Stainless



### Clam Shell V-Band

M6 Carriage Bolt



300 Stainless

Band with V-Insert



300 Stainless



90 in-lbs (10.2 Nm) for most applications